

HCMOS OSCILLATOR

J-Lead Plastic Surface Mount *EC17* Series 5.0V_{DC}



PART NUMBERING GUIDE

EC17 00 SJ ET I TS - 24.000M TR

FREQUENCY TOLERANCE / STABILITY

00=±100ppm Maximum (Standard)
45=±50ppm Maximum, 25=±25ppm Maximum

OPERATING TEMP. RANGE

Blank=0°C to 70°C
ET=-40°C to 85°C

DUTY CYCLE

Blank=50 ±10(%) (Standard)
T=50 ±5(%)

PACKAGING OPTIONS

Blank=Bulk
TR=Tape and Reel (Standard) (pg. L1)

FREQUENCY

PIN 1 CONNECTION

Blank=No Connection (Standard)
TS=Tri-State Enable High

ELECTRICAL SPECIFICATIONS

Marking Specifications See pg. G2, Group I

Frequency Range		70.000MHz to 125.000MHz
Operating Temperature Range		0°C to 70°C or -40°C to 85°C
Storage Temperature Range		-55°C to 125°C
Supply Voltage (V _{DD})		5.0V _{DC} ±10%
Input Current (I _{DD})	70.000MHz to 100.000MHz	50mA Maximum
	101.000MHz to 125.000MHz	65mA Maximum
Frequency Tolerance / Stability	Inclusive of Operating Temperature Range, Supply Voltage, and Load	±100ppm, ±50ppm or ±25ppm Maximum (0°C to 70°C Only)
Output Voltage Logic High (V _{OH})		V _{DD} - 0.5V _{DC} Minimum
Output Voltage Logic Low (V _{OL})		0.5V _{DC} Maximum
Rise Time / Fall Time	10% to 90% of Waveform	3 nSeconds Maximum
Duty Cycle	at 50% of Waveform	50 ±10(%) (Standard), 50 ±5(%) (Optional)
Load Drive Capability		15pF HCMOS Load Maximum
Pin 1 Tri-State Input Voltage	No Connection	Enables Output
	V _{IH}	+2.0V _{DC} Minimum to Enable Output
	V _{IL}	+0.8V _{DC} Maximum to Disable Output
Aging (at 25°C)		±5ppm / year Maximum
Start Up Time		10 mSeconds maximum
Period Jitter (Absolute)		±100pSeconds Maximum
Period Jitter (One Sigma)		±25pSec Maximum

MECHANICAL DIMENSIONS

Environmental / Mechanical Specifications See pg. H1, Group D

Pin 1: No Connect or Tri-State
Pin 2: Case Ground
Pin 3: Output
Pin 4: Supply Voltage

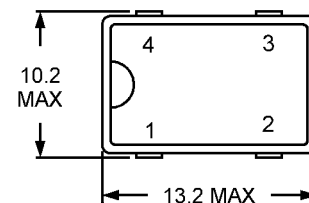
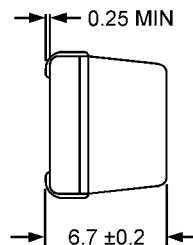
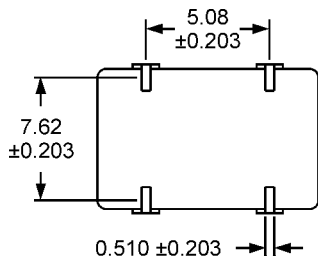

Dimensions in mm

3545 Cadillac Avenue, Costa Mesa, CA., 92626-1401 • Phone: (714) 433-1200 • Fax: (714) 433-1234

E13

Email: sales@ecliptek.com • Internet: <http://www.ecliptek.com>

Specifications subject to change without notice. • Contact factory for latest revision •1/99 • (OS50)